

## JTLJ Lower Hydraulic Jack

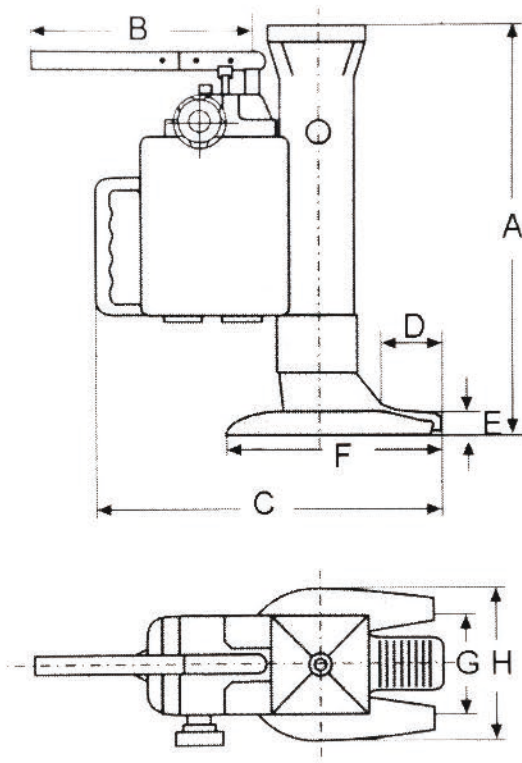

### Product introduction

- Compact and stable construction.
- Can be used in any position.
- Housing revolves 360 degrees.
- Lowering speed can be accurately adjusted.
- Protected against Overloading.
- Pump lever is removable.
- Meet ANSI/ASME PALD & CE/GS standards.

### Specifications

Model	Capacity	Lifting Range of Foot	Lifting Range of Head	Max.Lever Force	Net Weight
	(Ton)	(mm)	(mm)	(Kg)	(Kg)
JTLJ-7205	5	25-230(1.0" -9.0" )	368-573(14.5" -23.0" )	38(17.3lbs.)	25(11.4lbs.)
JTLJ-7210	10	30-260(1.2" -10.2" )	420-650(16.5" -25.6" )	40(18.2lbs.)	35(16.0lbs.)
JTLJ-7225	25	58-273(2.3" -11.0" )	505-720(20.0" -28.3" )	40(18.2lbs.)	102(46.4lbs.)