

## JTLC-C Horizontal Lifting Clamp

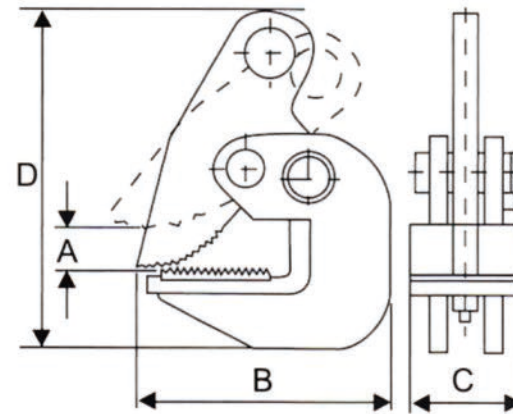

### Specifications

Model	Rated Capacity(t)	Test Load (t)	Jaw opening (mm)	N.W (Kg)
0.75T	0.75	1.5	0-25	2.4
1T	1	2	0-30	3.4
2T	2	4	0-35	5.4
3T	3	6	0-40	6
4T	4	8	0-45	6.3
5T	5	10	0-55	7.5